

INSTALLATION SPECIFICATIONS

Manual Installation

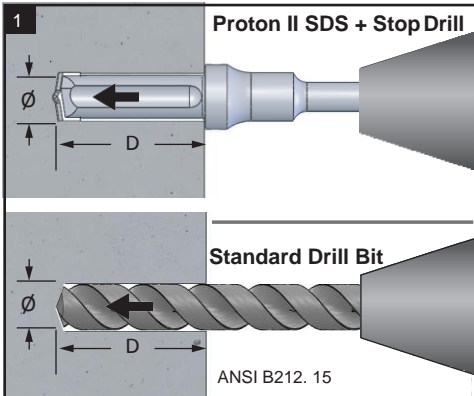

Drill hole into the base material to the depth of embedment required, using a Proton SDS + Stop Drill, or a standard drill bit.

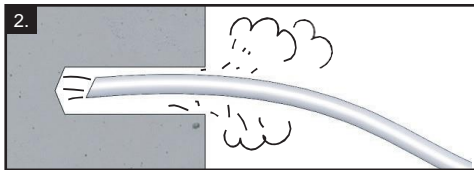

Clean the hole with compressed air or a proper dust removal tool to make sure there is no residual dust inside.

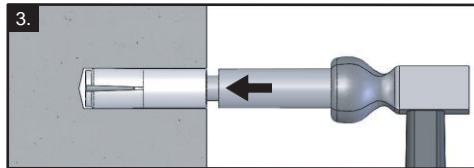

! Proton Manual Setting Tool must be used to set the anchor by driving the tool with a sufficient number of hammer blows.

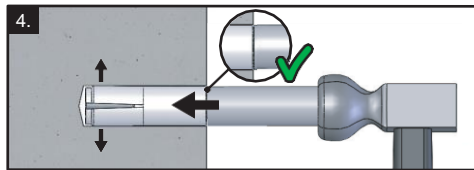

The anchor is set when the bottom of the setting tool makes full contact with the top surface of the anchor. Details on figure 5.

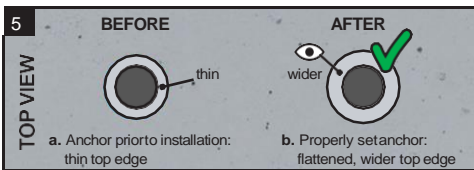

WARNING: Check that the anchor is properly set - the top edge of the anchor will become wider and flatter as a result of a setting mark of a properly set anchor. If the anchor has not been set properly repeat steps 1 to 4.

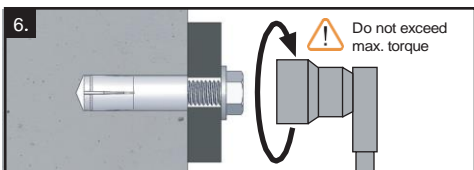

Position fixture, insert bolt and tighten until the tread engages properly. Refer to Installation Specification table for proper torque value (p.3).

Installation Using Proton SCX Drilling and Anchoring System

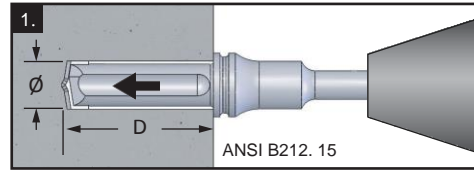

Drill hole into the base material to the depth of embedment required.

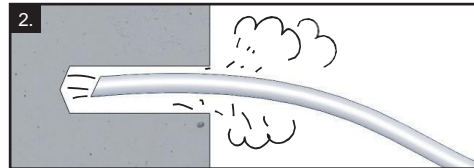

Clean the hole with compressed air or a proper dust removal tool to make sure there is no residual dust inside.

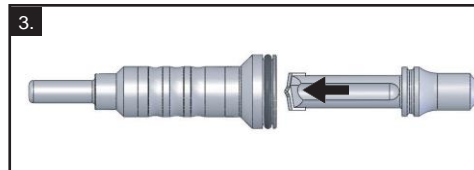

Connect the Proton Snap Fit Setting Tool to the Proton SCX Stop Drill.

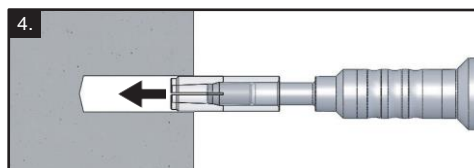

! Proton Snap Fit Setting Tool must be used to expand the anchor.

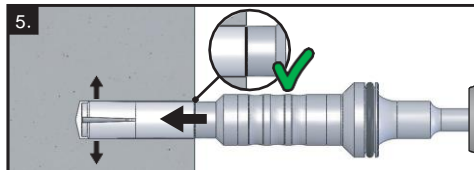

The anchor is set when the bottom of the setting tool makes full contact with the top surface of the anchor. Details on figure 6.

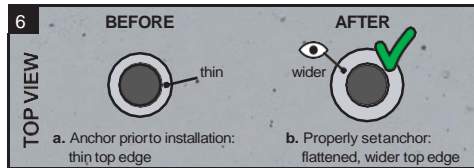

WARNING: Check that the anchor is properly set - the top edge of the anchor will become wider and flatter as a result of a setting mark of a properly set anchor. If the anchor has not been set properly repeat steps 1 to 5.

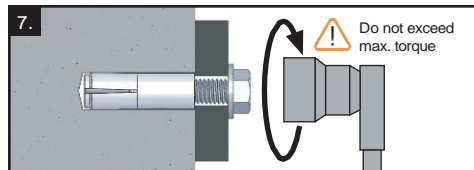

Position fixture, insert bolt and tighten until the tread engages properly. Refer to Installation Specification table for proper torque value (p.3).

